



LA7000 ALL-ELECTRIC LABEL APPLICATOR

The Diagraph LA7000 all-electric label applicator system is designed using servo-controlled label dispensing technology and smart sensing controls to achieve precise label placements at high speeds. Reduce manual interventions by remotely adjusting system settings and viewing system statuses across an entire fleet. Reliably wipe or tamp apply labels in various applications including to the side, top, bottom, front, rear and corner-wrap of product, case and pallet panels.

Independent rewind drive

Works as a clutch-less, no-adjustment system that is easy to web

Smart sensing technology

Detects missing labels at the peel point, advancing the web past missing label area to prevent double feeds and missed products

Brushless DC servo motor driven actuator

Drives precision label dispensing to achieve accurate, repeatable label placement

Color touchscreen display

Features an intuitive user interface that provides real-time reporting and onboard diagnostics



The LA7000 label applicator allows for reliable and accurate high speed applications using a variety wipe-on or tamp modules making for an easy transition away from hand labeling.

TECHNICAL DATA

Print engines	Available with Zebra or SATO print engines	
Dimensions (with yoke)	31" L x 27" H x 26" D	
Supply roll capacity	14" OD	
Core	3" diameter	
Label length	1" to 22"	
Label widths	*0.5" to 9"	
Product rate	E-Tamp: 120 PPM max.	E-FASA: Single apply: 52 PPM max. Dual apply: 28 PPM max.
Line speed	E-Tamp: 150 FPM max.	E-FASA: 75 FPM max.
Temperature	41° F to 104° F	
Humidity	10-85% relative humidity, non-condensing	
Controllers	Touch Pro, HH-4000	
Certifications	IEC 61000-6-2 2005/AC: 2005 Immunity, IEC 61000-6-4 2007/A1: 2011 Emission, FCC Part 15b, CSA CAN/CSA-C22.2 No. 62368-1:2014, UL62368-1:2014	



Scan for a full list of technical data.

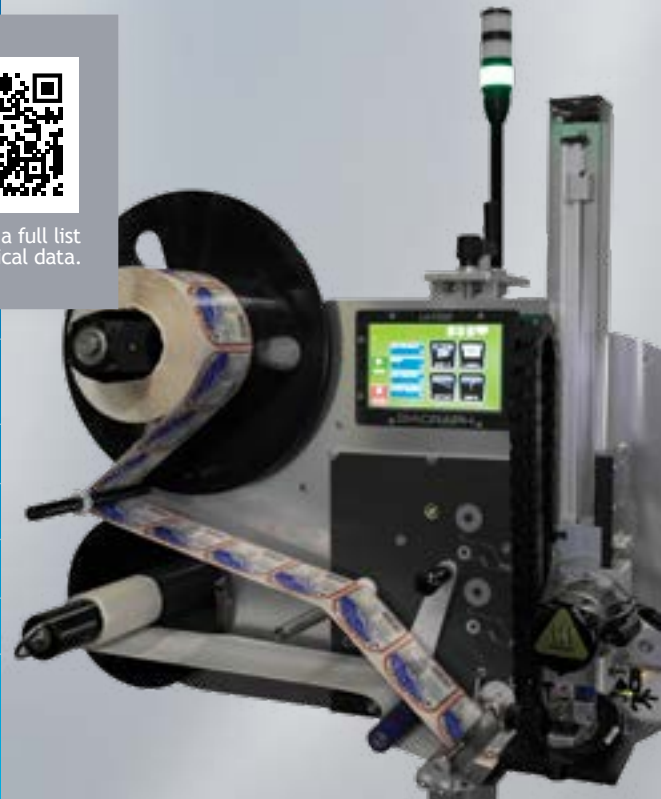

FEATURES & BENEFITS

- All-electric design frees manufacturers from the inconsistencies and high costs of plant air, enabling unparalleled one-to-one label-to-product placement
- Intelligent sensors ensure no missing or double-fed labels
- Remote access allows for setting adjustments and status checks to take place away from the line on a controller or PC

TECHNICAL DRAWINGS

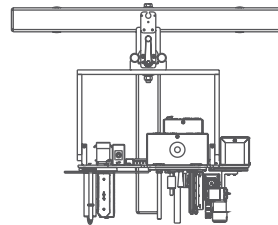

TAMP top down

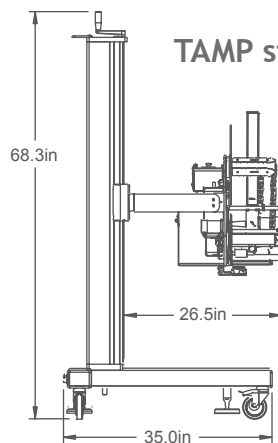

TAMP side

